



**SUPER  
SILENCED**

Soundproof canopy



Heavy duty



AVR

Super silenced generators equipped with Yanmar 1500 RPM engine. Compact and resistant, they are designed with on-board control panel and cover with security lock to ensure safe use, connector for automatic starting and three-phase and single-phase socket panel.

Central lifting hook and forkable base allow a practical handling.



# US-Y SS-Y SERIES STANDARD EQUIPMENT



## MG 16 - 23 U-SY

Controller with digital display for full monitoring of generator parameters: generator voltage, mains voltage, battery voltage, ammeter, frequency, hourmeter, oil pressure, engine temperature, fuel level, fail to start; with auto engine protection shutdown system in case of: fail to start, emergency stop, low oil pressure, low fuel level, high coolant temperature, oil pressure sender open circuit, over/under voltage, over/ under frequency

Starting battery  
3 x 16A - 230V single-phase sockets, 1 x 16A - 400V three-phase socket  
1 x 32A

Power outputs protections  
Earth Leakage Circuit Breaker (ELCB)  
Automatic voltage regulator (AVR)  
Connector for ATS panel and/or remote control  
Engine oil drain pipe  
Three-way valve  
Bunded tank  
Fork lift pockets  
Lifting hook

## MG 35 - 50 SS-Y

Controller with digital display for full monitoring of generator parameters: generator voltage, mains voltage, battery voltage, ammeter, frequency, hourmeter, oil pressure, engine temperature, fuel level, fail to start; with auto engine protection shutdown system in case of: fail to start, emergency stop, low oil pressure, low fuel level, high coolant temperature, oil pressure sender open circuit, over/under voltage, over/ under frequency;

Starting battery  
2 x 16A - 230V single-phase sockets, 4 x 32A - 230V single-phase sockets (MG 50 SS-Y)\*, 1 x 32A - 400V three-phase socket,  
1 x 63A - 400V three-phase socket

Power outputs protections  
Earth Leakage Circuit Breaker (ELCB)  
Automatic voltage regulator (AVR)  
Connector for ATS panel and/or remote control  
Engine oil drain pipe  
Three-way valve  
Bunded tank  
Fork lift pockets  
Lifting hook

\* 3 x 32A - 230V single-phase on MG 35 SS-Y

## DIMENSIONS IN MM

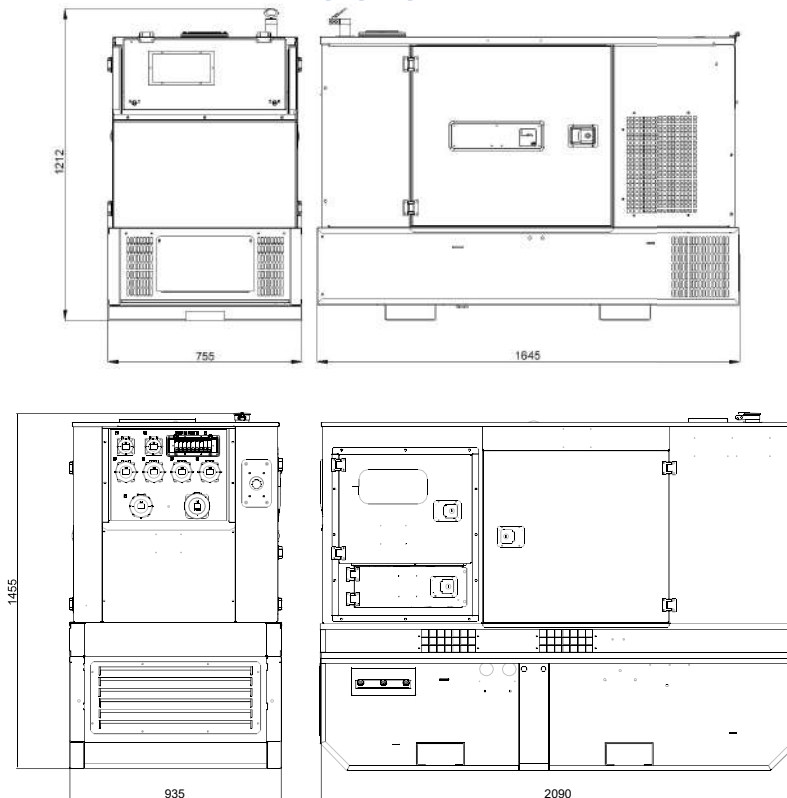

# US-Y SS-Y SERIES

# TECHNICAL DATA

	MG 16 US-Y	MG 23 US-Y	MG 35 SS-Y	MG 50 SS-Y
Noise level Lwa	92 (67 dB a 7 mt)			
AC generator-50Hz	Synchronous			
Three-phase max. power	16 kVA - 400 V	22 kVA - 400 V	33 kVA - 400 V	44 kVA - 400 V
Single-phase max. power	5,3 kVA - 230 V	7,3 kVA - 230 V	11 kVA - 230 V	14,7 kVA - 230 V
Power Factor	cos $\phi$ 0,8			
Yanmar 1500 RPM engine	3 TNV 88	4 TNV 88	4 TNV 98	4 TNV 98 T
Fuel	Diesel			
No. cylinders	3	4	4	4
Power	18,1 HP (13,5 kWm)	24,1 HP (18 kWm)	46,1 HP (34,4 kWm)	55,9 HP (41,7 kWm)
Displacement	1642 cm3	2190 cm3	3319 cm3	3319 cm3
Cooling system	Water			
Starting system	Electric			
Fuel tank capacity	70 lt		140 lt	
Fuel consumption @75%	2,7 lt/h	3,5 lt/h	6,4 lt/h	8,1 lt/h
Insulation Class	H			
Ambient temperature	40 °C			
Altitude	1000 mt			
Degree of protection	IP 23			
Dimensions (LxWxH)	1645x755x1212 mm		2090x935x1455 mm	
Dry weight	580 kg	610 kg	940 kg	1020 kg



## US-Y SS-Y SERIES

Options on request

- 1- Engine heater
- 2- Automatic refill system
- Spark arrester muffler
- 300 lt fuel tank\*
- Increased alternator (30kVA)\*\*

Accessories

- 3- ATS panel with mains sensor
- 4- Remote control
- GRT2W: 2 wheels site trailer

\* For MG 35 - 50 SS-Y models

\*\* For MG 23 US-Y model



### NOTE

---



---



---



---



---